

2322

SECTION CF

CARBURETTOR
MARK I

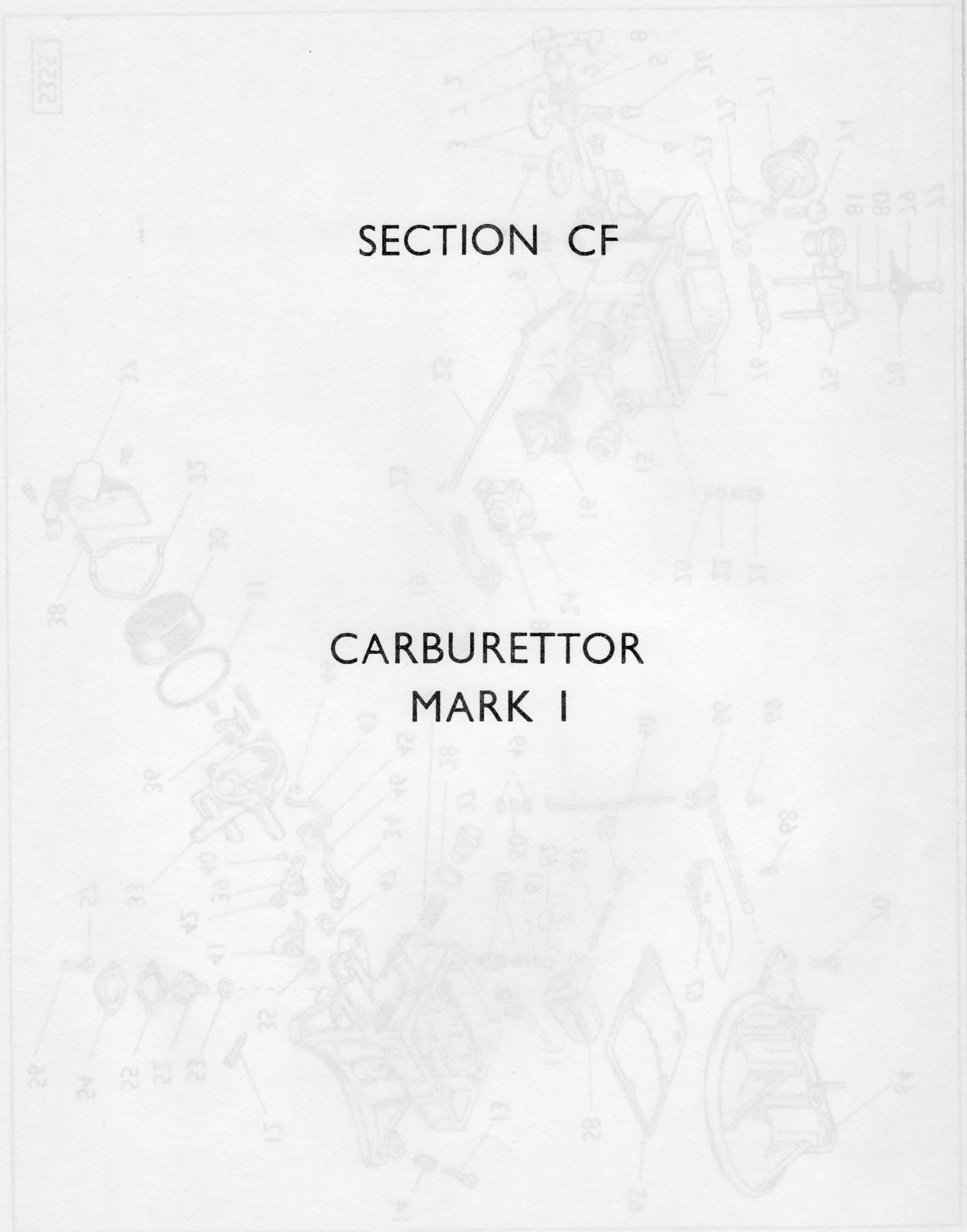

SECTION CF

CARBURETTOR—MARK I

5355

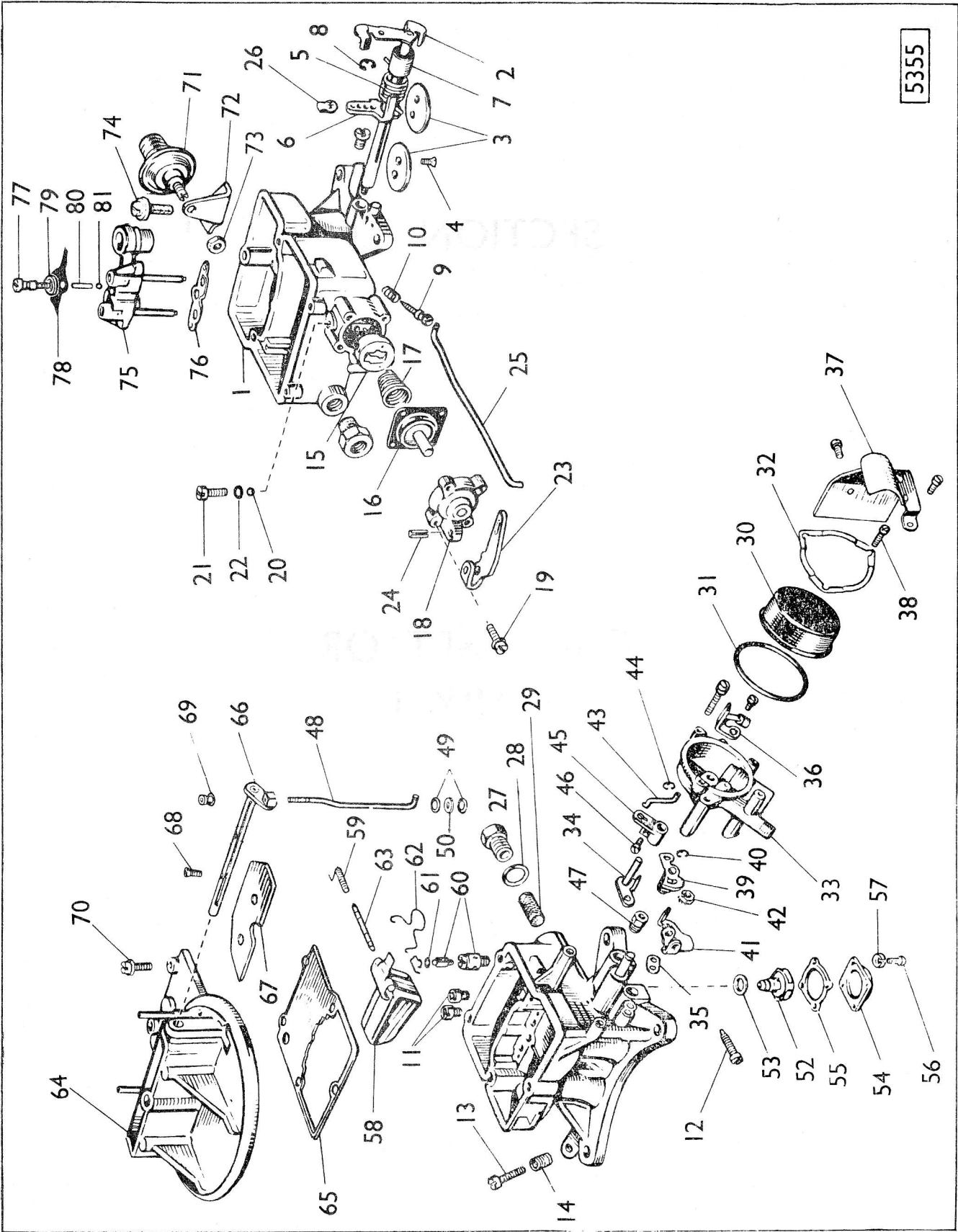

SECTION CF

CARBURETTOR — MARK I

Plate Ref.	Rootes Part Number	DESCRIPTION	No. per Vch.	REMARKS
	6100440	CARBURETTOR (2 Barrel)	1	Up to B9470592
	6100665	CARBURETTOR (2 Barrel)	1	From B9470593
1		Main body assembly		Not supplied
2	6100340	Shaft and lever	1	
3	6100341	Plate	2	} Throttle
4	6100615	Screw—Plates to shaft	4	
5	6100450	Spring	1	
6	6100354	Lever and bush	1	} Accelerator pump overtravel
7	6100455	Bush	1	
8	6100479	Retainer—Pump overtravel lever to throttle shaft	1	
	6100355	Retaining ring, $\frac{1}{8}$ "—Lever to shaft	1	
		Plug, $\frac{5}{16}$ "—Blanking main body		} Not supplied
		Plug (to plug hole from bowl to accelerator pump)		
9	6100321	Needle—Idle adjusting	2	
10	6100337	Spring—Fast idle adjusting lever (.20" I/D \times .58" long)	1	
11	6100313	Main metering jet—Tag code C4DF-E No. 44F—0 to 5000 ft. altitude	2	} See * below
	6100314	Main metering jet—Tag code C4DF-K/R No. 42F—0 to 5000 ft. altitude	2	
	6100314	Main metering jet—Tag code C4DF-T No. 42 F—0 to 5000 ft. altitude	2	} See ** below
	6100314	Main metering jet—No. 42F—5,000 to 10,000 ft. altitude	2	
	6100315	Main metering jet—No. 40F—5,000 to 10,000 ft. altitude	2	} From B9470593
	6100315	Main metering jet—No. 40F—10,000 to 15,000 ft. altitude	2	
	6100685	Main metering jet—No. 38F—10,000 to 15,000 ft. altitude	2	} From B9470593
	6100316	Main metering jet—Tag code C4DF-F No. 43F—0 to 5,000 ft. altitude	2	
	6100316	Main metering jet—Tag code C4DF-JN No. 43F—0 to 5,000 ft. altitude	2	} See * below
	6100316	Main metering jet—Tag code C4DF-S No. 43F—0 to 5,000 ft. altitude	2	
	6100317	Main metering jet—No. 41F—5,000 to 10,000 ft. altitude	2	} See ** below
	6100318	Main metering jet—No. 39F—10,000 to 15,000 ft altitude	2	
12	6100451	Screw—Fast idle adjusting	1	
13	6100614	Screw—Normal idle adjusting—No. 10 \times 1" special hex. hd. slotted	1	
14		Spring—Idle adjusting needle		Not supplied
15	6100333	Filler—Accelerator pump cavity	1	Up to B9470592
16	6100327	Diaphragm—Accelerator pump	1	Up to B9470592
	6100688	Diaphragm—Accelerator pump	1	From B9470593
17	6100345	Spring—Pump lever return	1	See * below
	6100696	Spring—Pump lever return	1	From ** below & B9470593
18	6100308	Cover—Accelerator pump—less link	1	Up to B9470592
	6100681	Cover—Accelerator pump—less link	1	From B9470593
19	6100608	Screw and washer No. 8 \times $\frac{5}{8}$ "—Cover to carb	4	Up to B9470592
	6100682	Screw and washer No. 8 \times $\frac{9}{16}$ "—Cover to carb	4	From B9470593
20	9187004	Ball, $\frac{3}{16}$ " steel	1	} Up to B9470592
21	6100485	Screw	1	
22	6100612	Washer, $\frac{1}{4}$ " plain	1	} From B9470593
	6100695	Valve, plastic	1	
23	6100309	Link	1	See * below
	6100683	Link } Accelerator pump	1	See ** below
	6100684	Link }	1	From B9470593

*For Carburetors with Stamping or Tag Identification C4DF-F.
 **For Carburetors with Stamping or Tag Identification C4DF-N.

CARBURETTOR — MARK I

Plate Ref.	Rootes Part Number	DESCRIPTION	No. per Veh.	REMARKS
		CARBURETTOR—continued		
24	6100310	Pin—Accelerator pump link to cover (.187" × .50") ...	1	Up to B9470592
25	6100322	Rod—Accelerator pump link to throttle lever (Includes 5—375894-S7 clips) ...	1	Up to B9470592
	6100686	Rod—Accelerator pump to overtravel lever ...	1	From B9470593
26	6100484	Clip—Accelerator pump link to throttle lever rod to overtravel pump lever ...	1	
	6100481	Retainer—Pump link—.48" I/D (Use with C2AZ-9564-B)	1	
27	6100305	Adaptor ...	1	
28	6100303	Gasket } Fuel inlet ...	1	} Up to B9470592
29	6100357	Filler ...	1	
30	6100349	Cover—Choke thermost (Identified by letters "TN")—Service package includes 1-C1AE-9871-A Gasket—Tag code C4DF-E ...	1	
	6100694	Cover—Choke thermost (Identified by letters "TO")—Service package includes 1-C1AE-9871-A Gasket—Tag codes C4DF-K/R ...	1	
	6100349	Cover—Choke thermost (Identified by letters "TN")—Service package includes 1-C1AE-9871-A Gasket—Tag codes C4DF-J/N ...	1	} See ** below
	6100694	Cover—Choke thermost (Identified by letters "TO")—Service package includes 1-C1AE-9871-A Gasket—Tag code C4DF-T ...	1	
	6100349	Cover—Choke thermost (Identified by letters "TN")—Service package includes 1-C1AE-9871-A Gasket—Tag code C4DF-S ...	1	} From B9470593
31	6100353	Gasket } Thermostat ...	1	
32	6100348	Clamp ... } choke housing ...	1	
	6100336	Housing assembly } Choke ...	1	
33	6100350	Housing and plugs ...	1	
34	6100346	Shaft and lever—Choke housing ...	1	
35	6100351	Gasket—Thermostatic choke housing ...	1	
36	6100347	Piston assembly—Choke ...	1	
	6100692	Lever—Fast idle cam (Nylon) ...	1	
37	6100352	Shield—Choke thermost ...	1	
38	6100545	Screw—Thermostatic choke housing cover ...	3	
	6100691	Screw No. 8 × 1.76"—Choke housing to main body ...	3	
39	6100343	Cam } Fast ...	1	} See * below
	6100693	Cam } idle ...	1	
40	6100312	Retainer—Fast idle cam ("C" washer) ...	1	} From ** below & B9470593
41	6100320	Lever—Fast idle adjusting ...	1	
42	6100609	Nut ... } Lever to ...	1	
	6100610	Lock washer, No. 10 } throttle shaft ...	1	
	6100339	Pin—Fast idle adjusting lever ...	1	
43	6100311	Rod—Fast idle cam ...	1	
44	6100312	Retainer—Fast idle cam rod ...	2	
45	6100320	Overtravel lever ...	1	
46	6100673	Adjusting screw—Overtravel lever ...	1	
47	6100486	Connector—Distributor vacuum tube to carb ...	1	} See * below
48	6100344	Rod—Choke control ...	1	
49	6100480	Washer—Choke rod seal ...	2	} Not supplied
50		Seal—Choke rod ...		

*For Carburetors with Stamping or Tag Identification C4DF-F.
 **For Carburetors with Stamping or Tag Identification C4DF-N.

CARBURETTOR — MARK I

Plate Ref.	Rootes Part Number	DESCRIPTION	No. per Veh.	REMARKS
CARBURETTOR—continued				
52	6100332	Economizer (Identified by black dye on body)	1	
53	6100342	Gasket—Economizer	1	
54	6100356	Cover—Economizer valve	1	
55	6100329	Gasket—Economizer cover	1	
56	6100616	Screw ... } Cover to	4	
57	6100617	Lock washer } main body	4	
	6100458	Bracket—Accelerator return spring	1	
58	6100324	Float and lever assembly	1	
59	6100335	Spring—Float dampener	1	
60	6100331	Valve and seat ... } Fuel	1	Superseded by 6100690
	6100690	Valve and seat kit } inlet	1	
61		Gasket—Float valve seat		} Not supplied separately
62		Retainer—Float lever shaft		
63	6100326	Pin—Float hinge	1	
64	6100307	Float chamber cover and air horn (less shaft)	1	See * below
	6100680	Float chamber cover and air horn (less shaft)	1	See ** below
65	6100328	Gasket } Float	1	See * below
	6100689	Gasket } bowl	1	See ** below
66	6100323	Shaft and lever } (Superseded by 6100687)	1	See * below
	6100687	Shaft and lever } Choke	1	See ** below
67	6100452	Plate	1	
68	6100601	Screw—No. 6 × .31" pan hd.—Choke plate	2	
69	6100544	Nut—Choke plate adjusting	1	
70		Screw and washer—No. 10 × $\frac{5}{8}$ "—Float chamber cover to main body		Not supplied
71	6100453	Dashpot	1	
72	6100454	Bracket—Dashpot mounting	1	
73	6100571	Nut, $\frac{5}{8}$ " ... } Dashpot to	1	
	9661203	Lock washer, $\frac{5}{16}$ " } bracket	1	
74	6100611	Screw and washer—No. 10 × $\frac{1}{2}$ "—Dashpot mounting bracket to carburettor	1	
75	6100306	Support—Booster venturi (Identified by letter "H")	1	See * below
	6100679	Support—Booster venturi (Identified by letters "CA")	1	See ** below
76	6100319	Gasket—Booster venturi support	1	
77	6100456	Screw—Pump discharge nozzle	1	
78	6100325	Plate—Air distribution	1	
79	6100613	Washer, $\frac{1}{4}$ " plain—Buna coated aluminium	1	
80	6100543	Weight, $\frac{1}{8}$ " O/D—88" long—Pump discharge ball	1	
81	9187004	Ball, $\frac{5}{16}$ " steel—Accelerator pump discharge valve	1	
	6100300	GASKET SET	1	See * below
	6100676	GASKET SET	1	See ** below
	6100301	TUNE-UP KIT	1	Up to B9470592
	6100677	TUNE-UP KIT	1	From B9470593
	6100302	REPAIR KIT	1	See * below
	6100678	REPAIR KIT	1	See ** below

*For Carburetors with Stamping or Tag Identification C4DF-F.
 **For Carburetors with Stamping or Tag Identification C4DF-N and from Chassis Number B9470593.